



Adjustable Height Support



happymaker

[VIEW IN BROWSER](#)

updated 13. 7. 2024 | published 13. 7. 2024

Summary

It can replace a furniture leg, act as a door or window stopper, provide temporary support for glued parts, etc.

[Household](#) > [Other House Equipment](#)

Tags: [leg](#) [window](#) [door](#) [support](#) [furniture](#) [jack](#) [glue](#)
[adjustable](#) [stopper](#) [screw](#) [thread](#) [simple](#) [height](#)

It is a simple mechanism that provides column-like support for structures that require it. The support has a dynamic height that **can be adjusted in place of use** to lock it.

To change the support height, fix it with your hand on a surface and use a lever to unscrew the top part to the needed extent. For it, put a lever in one of the holes, rotate the top part, and repeat the process if needed. The **best lever is a screwdriver**, but there are many alternatives. You can also print a lever.

The mechanism is capable of supporting heavy objects. It was tested by taking 75 kg of mass, but I'm sure it can do more. It can be a suitable replacement for a broken furniture leg or temporary support in assembling constructions. Alternatively, the support can be used to lock another mechanism in place. For example, it can fix a window in a semi-opened position.

The support's height varies from **32 mm to 102 mm**. Due to technical specifics, **three different models** cover this adjustment range. Depending on your requirements, pick the appropriate model to print.

To reliably fix the support in place, **add a couple of mm to the actual range** you need to cover. If the provided models do not cover the required range, you can try scaling or combining supports.

Print with **at least four walls**. No supports. Works well in regular PLA.

If you have some flexible filament like **TPU** and want to protect contact surfaces from scratches and/or improve the stability of the support, check out [this remix](#).

Model files



adjustable-support-32-42-mm-top.stl



adjustable-support-32-42-mm-bottom.stl

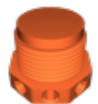

adjustable-support-42-62-mm-top.stl



adjustable-support-42-62-mm-bottom.stl



adjustable-support-62-102-mm-top.stl



adjustable-support-62-102-mm-bottom.stl



adjustable-support-lever.stl

☐ Optional. It can be replaced by a screwdriver, pen, etc.

License

This work is licensed under a
Creative Commons (4.0 International License)



Attribution-ShareAlike

- ✗ | Sharing without ATTRIBUTION
- ✓ | Remix Culture allowed
- ✓ | Commercial Use
- ✓ | Free Cultural Works
- ✓ | Meets Open Definition